

# LAPspay Systems for Dogs and Cats

Laparoscopic Ovariectomy / Ovariohysterectomy  
Single and Multi-Port



## LAPspay Multi-Port

### Standard Laparoscope



- 62046 AA **HOPKINS® Straight Forward Telescope 0°**, enlarged view, diameter 5 mm, length 29 cm, **autoclavable**, fiber optic light transmission incorporated, color code: green

### TERNAMIAN ENDOTIP Cannulas

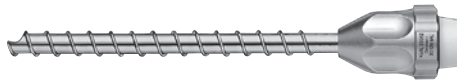

- 60120 MS TERNAMIAN **ENDOTIP Cannula**, size 6 mm, color code: black-white including:  
**Cannula**, with thread, working length 6.5 cm  
**Silicone Leaflet Valve**
- 60120 MSS **Same**, with insufflation stopcock

### Standard Trocar and Cannula, with multifunctional valve

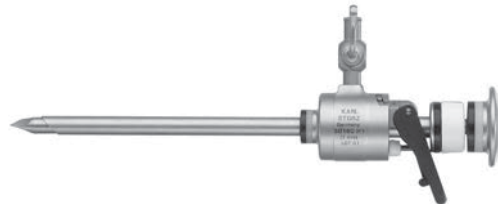

- 62160 WZ **Trocar**, size 6 mm, color code: black-white including:  
**Trocar**, only, with pyramidal tip  
**Cannula**, without valve, with insufflation stopcock, working length 8.5 cm  
**Multifunctional Valve**

## LAPspay Single Port

### Operating Laparoscope

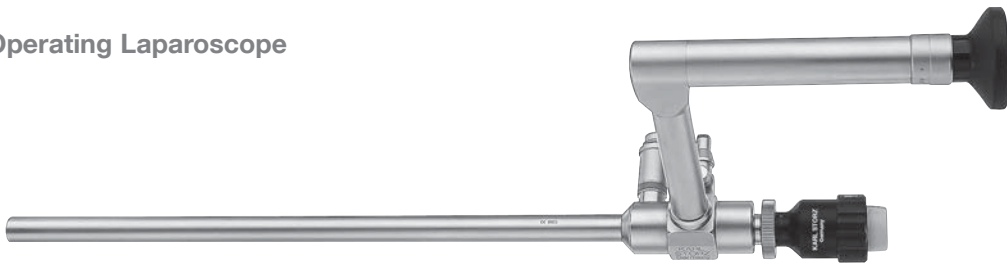

26034 AAV **HOPKINS® Operating Telescope 0°**, with parallel eyepiece, diameter 10 mm, length 23 cm, **autoclavable**, fiber optic light transmission incorporated, with 6 mm working **channel**, including adaptor with Silicone Leaflet Valve 26034 V

### TERNAMIAN ENDOTIP Cannula, with multifunctional valve

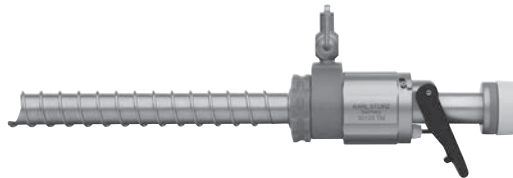

60103 TMR TERNAMIAN **ENDOTIP** Cannula, with thread and rotatable insufflation stopcock, size 11 mm, working length 10.5 cm, color code: green  
including:  
**Cannula**  
**Multifunctional Valve**  
**Seal Set 60/10**  
**Mandrel**, for opening automatic valves

### Standard Trocar and Cannula

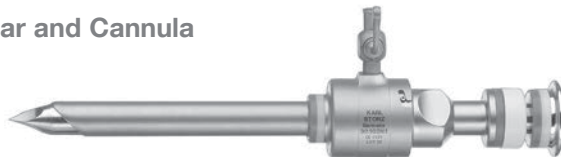

62103 FZ **Trocar**, size 11 mm, color code: green  
including:  
**Trocar**, only, with pyramidal tip  
**Cannula**, without valve, with insufflation stopcock, working length 8.5 cm  
**Automatic Valve**



62141 DB **Reducer**, 11/5 mm

**Whether you prefer the Multi-Port or Single-Port technique, minimally invasive ovariectomy and ovariectomy using a KARL STORZ LAPspay surgery system offers the following advantages:**

- Unsurpassed optics for a clear, bright, enlarged view
- Less pain for the patient since tissues are cauterized and transected with precision, rather than torn
- Complications, such as wound dehiscence, ovarian remnants and ligated ureters, are reduced to a minimum
- Reduced chance of infection due to minimal exposure of the abdomen
- Faster recovery due to small incision size
- Satisfied clients who demand the best for their pets
- Practice expansion through state-of-the-art surgical services
- The opportunity to improve your laparoscopy skills, which can be applied to numerous other minimal access surgical techniques



## Instruments, 5 mm



66322 MG

**CLICKLINE Grasping Forceps**, “tiger jaws”, rotating, dismantling, insulated, with connector pin for unipolar coagulation, with LUER-Lock irrigation connector for cleaning, single action jaws, 2 x 4 teeth, for grasping and removal of solid organs, size 5 mm, length 36 cm including:

**Plastic Handle**, with MANHES style ratchet

**Metal Outer Sheath**, insulated

**Forceps Insert**

33422 MG

**Same**, length 43 cm

## Additional Instruments



62175 H

**TANKERSLEY Ovariectomy Hook**, with heavy handle, for percutaneous use, working length 8.5 cm

62175 HK

**Same**, with small hook, for small dogs and cats



62120 J

**VERESS Pneumoperitoneum Needle**, with spring-loaded blunt stylet, LUER-Lock, diameter 2.1 mm, length 10 cm

## Camera System



- 69 2360 01 **Veterinary Video Camera III**, color system PAL, power supply 100-240 VAC, 50/60 Hz including:  
**Veterinary Video Camera III Camera Control Unit**, color systems **PAL/NTSC**, with integrated digital fiberscope filters  
**Mains Cord**  
2x **ACC Connecting Cable**, for controlling KARL STORZ units, length 180 cm  
**BNC Video Cable**, length 200 cm  
**S-Video (Y/C) Connecting Cable**, length 180 cm  
**C-MOUNT Lens**, f = 38 mm, soakable  
**VET C-MOUNT Camera Head, PAL**

- 69 2361 01 **Same**, color system NTSC

## Light Source



- 69 1315 01 **Cold Light Fountain XENON NOVA® 175**, power supply 100-240 VAC, 50/60 Hz including:  
**Mains Cord**
- 20 1320 26 **XENON Spare Lamp**, 175 W, 15 V
- 69495 NA **Fiber Optic Light Cable**, with straight connector, diameter 3.5 mm, length 230 cm (not illustrated)

For other camera system and light source options, see catalog: *Veterinary Endoscopy, Small Animals*

## Insufflator



- 624325 01 CO<sub>2</sub> ENDO-ARTHROFLATOR-VET**,  
power supply 100-240 VAC, 50/60 Hz  
including:  
**Silicon Tubing Set**, sterilizable  
**Universal Wrench**  
**Gas Filter**, sterile, for single use,  
package of 10

The pressure hose and CO<sub>2</sub> bottles must be ordered separately

## Electrosurgical Unit



- 205308 01 AUTOCON® II 80**,  
power supply 100-240 VAC, 50/60 Hz  
including:  
**Mains Cord**
- 20017834 Two-Pedal Footswitch**, digital, one-stage
- 26176 LE Bipolar High Frequency Cord**, length 300 cm,  
for AUTOCON® II 400 SCB system (111, 113, 115,  
122, 125), AUTOCON® II 200, AUTOCON® II 80,  
Coagulator 26021 B/C/D, 860021 B/C/D, 27810 B/C/D,  
28810 B/C/D, AUTOCON® system (50, 200, 350),  
Erbe-Coagulator, T and ICC series



KARL STORZ GmbH & Co. KG  
Mittelstraße 8, 78532 Tuttlingen, Germany  
Postbox 230, 78503 Tuttlingen, Germany  
Phone: +49 (0)7461 708-0  
Fax: +49 (0)7461 708-105  
E-Mail: [vet@karlstorz.com](mailto:vet@karlstorz.com)

[www.karlstorz.com](http://www.karlstorz.com)